

MAIN FLOOR

SITE AREA = SEE ALLOY PROPERTIES PLAN
 BUILDING AREA = 28867 SQ. FT.(2682.0 sq.m.)
 (MAIN FLOOR) = 10414 SQ. FT.(967.5 sq.m.)

979 ALLOY DRIVE
 THUNDER BAY, ONTARIO

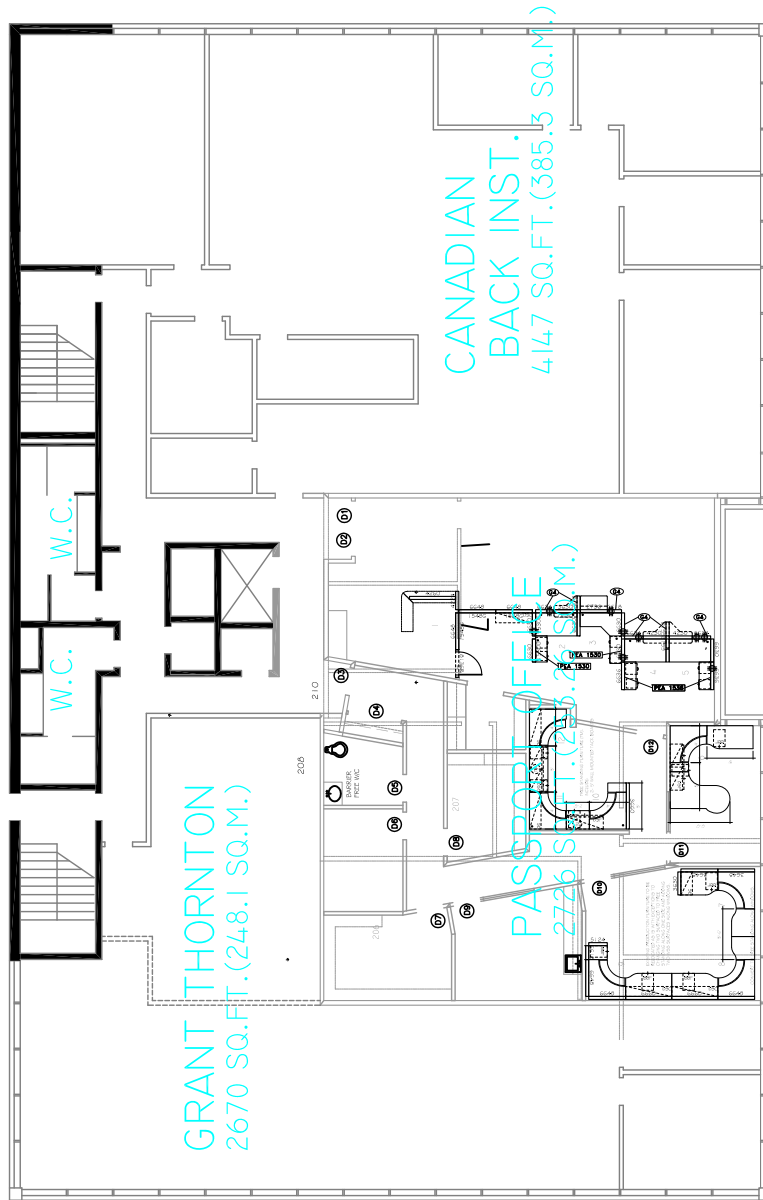

SECOND FLOOR

SITE AREA = SEE ALLOY PROPERTIES PLAN
 BUILDING AREA = 28867 SQ. FT.(2682.0 SQ.M.)
 (MAIN FLOOR) = 10414 SQ. FT.(967.5 SQ.M.)

979 ALLOY DRIVE
 THUNDER BAY, ONTARIO

